

# SOFTTEL

## Technical Specification

### Optical Fiber Cable Distribution Box

### SPD-24N

Customer Approval			
	Name	Signature	Date
Approved by			

# Contents

1. General.....	2
1.1 Description.....	2
1.2 Standards Comply.....	2
1.3 Applications Environment.....	2
2. Characteristics.....	3
3. Specifications.....	3
4. Configuration.....	4
5. Product Picture.....	4
6. Environmental characteristics.....	5
7. Installation:.....	5
1. Wall-mounted installation.....	5
2. Pole-mounted installation.....	5
8. Package.....	5

# 1. General

## 1.1 Description

The equipment is used as a termination point for the feeder cable to connect with drop cable in FTTx communication network system. The fiber splicing, splitting, distribution can be done in this box, and meanwhile it provides solid protection and management for the FTTx network building.

Production type	Classification
SPD-24N	Optical fiber cable distribution box



Appearance of SPD-24N

## 1.2 Standards Comply

The production offered by FTTXTECH are designed, manufactured and tested according to the standards as follows:

ITU-T G.652	Characteristics of a single-mode optical fibre
IEC 60794-1-1	Optical fibre cables-part 1-1: Generic specification-General
IEC 60794-1-2	Optical fibre cables-part 1-2: Generic specification-Basic optical cable test procedure

## 1.3 Applications Environment

Item	Value
Operation temperature	-40 °C~+65 °C
Installation temperature	-5 °C~+40 °C
Storage temperature	-40°C~+65 °C
Atmospheric pressure	70~106Kpa
Relative humidity	≤93%(+40°C)

## 2. Characteristics

- Total enclosed structure.
- Material: PC+ABS, wet-proof, water-proof, dust-proof, anti-aging, protection level up to IP65.
- Clamping for feeder cable and drop cable, fiber splicing, fixation, storage, distribution...etc all in one.
- Cable, pigtails, patch cords are running through own path without disturbing each other, cassette type SC adaptor installation, easy maintenance.
- Distribution panel can be flipped up, feeder cable can be placed in a cup-joint way, easy for maintenance and installation.
- Cabinet can be installed by the way of wall-mounted or poled-mounted, suitable for both indoor and outdoor uses.

## 3. Specifications

### 3.1 Mechanical specifications

Item	Specifications	Remark
External dimension(mm)	330*210*87(A*B*C)	
Installation hole position(mm)	175.5*121*250(DxExF)	
Color	PANTONE 428C	Customizable
Size and quantity of optical cable hole	One pair of straight hole, 2pcs of divergent hole and 24pcs of household	
Input type/type of output	SC adapter	
Capacity(Max)	24 cores	
Into the largest cable diameter (mm)	15	
Cable outlet size(mm)	2*3~ $\varnothing$ 5	
IP protection level	IP65	
Flammability	HB(Conventional)	can be customized
Neutral salt spray test (NSS)	48 h	according to requirements

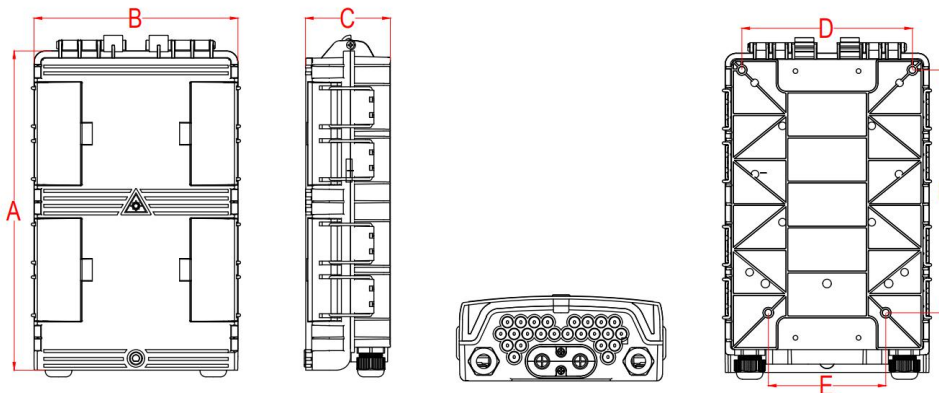

## 4. Configuration

### 4.1 Main parts

Part name	Unit	Quantity	Note
1*8 PLC Type Fiber Optic Splitter	pcs	2	
SC adapter	pcs	24	

## 5. Product Picture

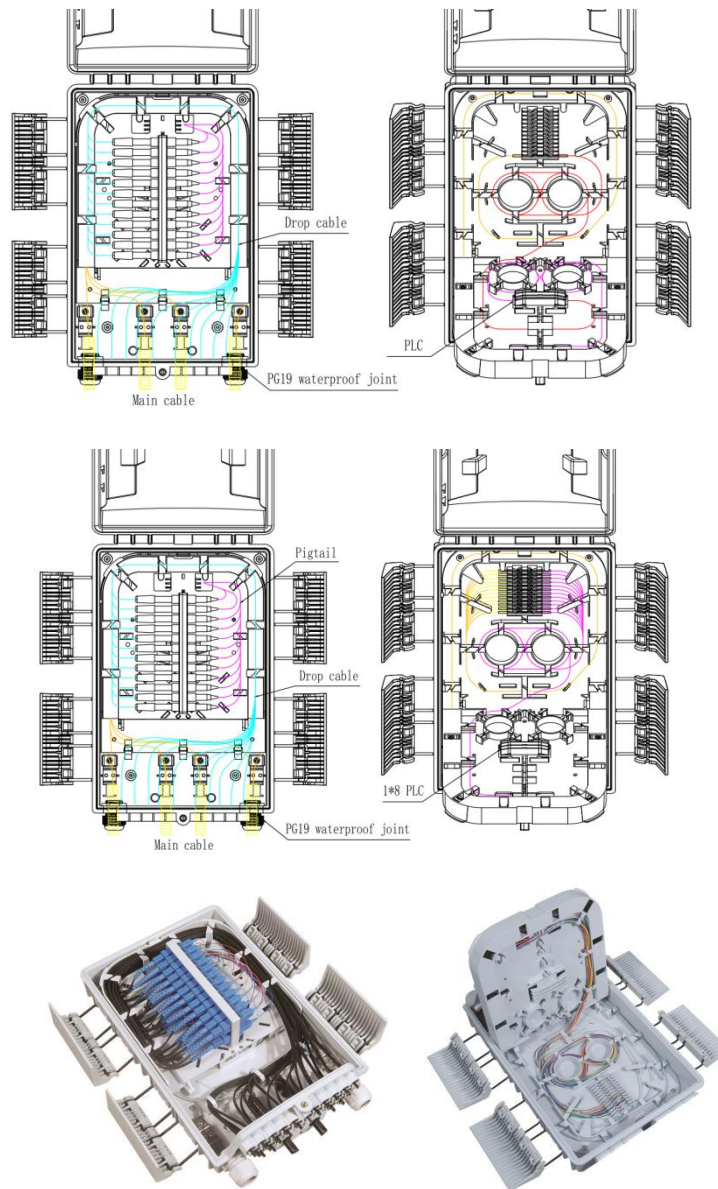

SPD-24N product picture

## 6.Environmental characteristics

This product complies with the RoHS environmental protection directive, and the content of lead, cadmium, mercury, hexavalent chromium, polybrominated biphenyl (PBB) and polybrominated diphenyl ether (PBDE) does not exceed the limit.

## 7. Installation:

### 1. Wall-mounted installation

Drill 4 holes into the wall based on the size in table 1, place the expansion bolt  $\Phi 7.5*40$ , place the box to match up the holes and use bolt to fasten.

### 2. Pole-mounted installation

Fix 1 set of the pole ring to the telecom pole

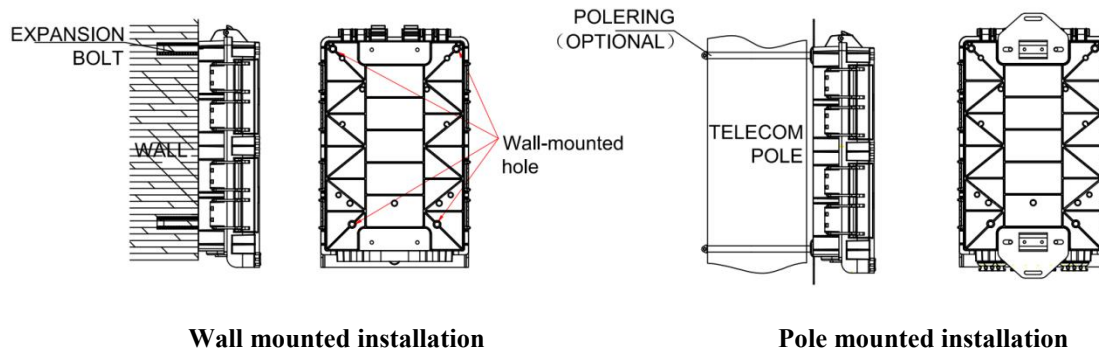

## 8.Package

1PC in a bubble bag, 420\*350mm ;

1PC in a small carton, 360\*235\*100mm, gross weight is 1.78kg ;

10PCS in a big corrugated carton, 490\*375\*545 mm, gross weight is 20.3kg.